

Copyright© 2005 by Big Bike Parts, Inc.  
No part of this instruction sheet may be  
reproduced without the written permission  
of Big Bike Parts, Inc.

REVISED 09/25/08

- ITEMS REQUIRED:** (1) MG HEX ALLEN WRENCH  
(2) MG X 1.0 X 20 ALLEN HEAD SCREWS  
(1) EXTENDER COVER  
(1) CLAMP COVER

**INSTALLATION:**

1. PLACE THE MOTORCYCLE ON ITS CENTER STAND AND PLACE THE KICKSTAND (1A) IN THE "DOWN" POSITION.
2. PLACE THE EXTENDER COVER (1B) AND THE CLAMP COVER (1C) ON THE KICKSTAND (1A) AND SECURE WITH THE TWO ALLEN HEAD SCREWS (1D) AS SHOWN. THE EXTENDER COVER (1B) WILL BE TO THE REAR OF THE MOTORCYCLE. DO NOT OVER TIGHTEN THE ALLEN SCREWS (1D) AS SOME GAP IS NECESSARY BETWEEN THE EXTENDER COVER (1B) AND CLAMP COVER (1C).
3. SWING THE KICKSTAND (1A) INTO THE "UP" POSITION MAKING SURE THE EXTENDER DOES NOT INTERFERE WITH ANY PARTS OF THE MOTORCYCLE.

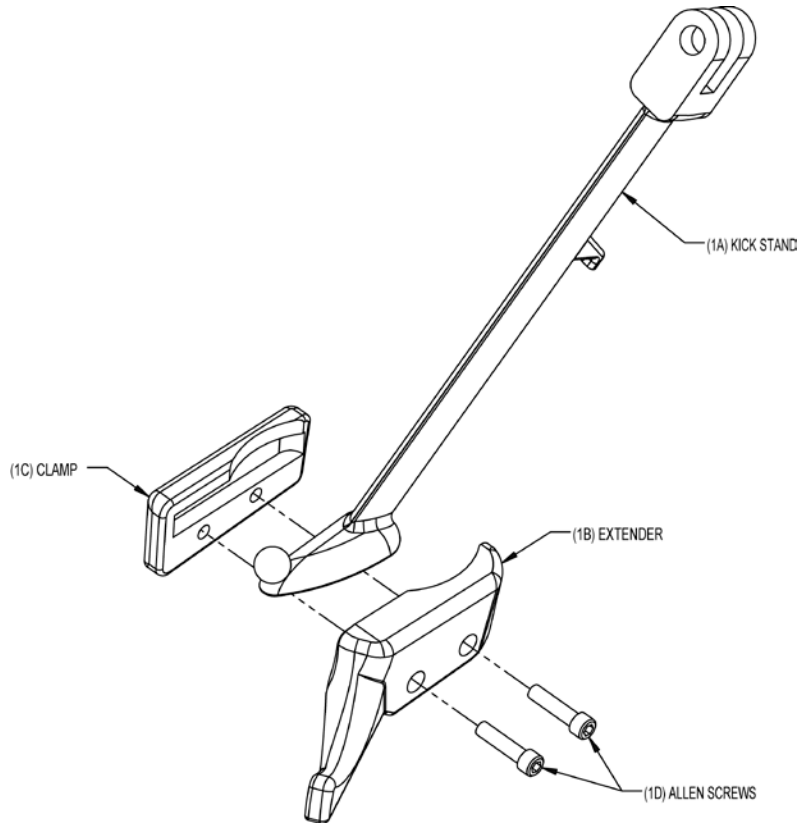

Copyright© 2005 by Big Bike Parts, Inc.  
No part of this instruction sheet may be  
reproduced without the written permission  
of Big Bike Parts, Inc.

REVISED 09/25/08

- ITEMS REQUIRED:** (1) MG HEX ALLEN WRENCH  
(2) MG X 1.0 X 20 ALLEN HEAD SCREWS  
(1) EXTENDER COVER  
(1) CLAMP COVER

**INSTALLATION:**

1. PLACE THE MOTORCYCLE ON ITS CENTER STAND AND PLACE THE KICKSTAND (1A) IN THE "DOWN" POSITION.
2. PLACE THE EXTENDER COVER (1B) AND THE CLAMP COVER (1C) ON THE KICKSTAND (1A) AND SECURE WITH THE TWO ALLEN HEAD SCREWS (1D) AS SHOWN. THE EXTENDER COVER (1B) WILL BE TO THE REAR OF THE MOTORCYCLE. DO NOT OVER TIGHTEN THE ALLEN SCREWS (1D) AS SOME GAP IS NECESSARY BETWEEN THE EXTENDER COVER (1B) AND CLAMP COVER (1C).
3. SWING THE KICKSTAND (1A) INTO THE "UP" POSITION MAKING SURE THE EXTENDER DOES NOT INTERFERE WITH ANY PARTS OF THE MOTORCYCLE.

