

BIG BIKE PARTS® INSTALLATION INSTRUCTIONS

TOUR CORNER LIGHT GRILLE
PART NO. 2-481

FOR HONDA GL1500/6
GOLD WING MODEL

Copyright© 1998 by Big Bike Parts, Inc. No part of this instruction sheet may be reproduced without the written permission of Big Bike Parts, Inc.®

Revised 7/25/2017

ITEMS REQUIRED: #2 PHILLIPS SCREWDRIVER CENTER PUNCH
 FLAT BLADE SCREWDRIVER 3/16" DRILL BIT & ELECTRIC DRILL
 HAMMER

NOTE: WE RECOMMEND THIS PART BE PROFESSIONALLY INSTALLED WITH CARE TO AVOID DAMAGE TO YOUR BIKE OR THE NEW PART.

INSTALLATION:

1. REMOVE THE FOLLOWING:

- A) PULL OUTWARD ON THE FAIRING FRONT COVER (1A) TO DISENGAGE THE BOSSES (1B) FROM THE FAIRING PANEL COVERS (2A).
- B) USING THE FLAT BLADE SCREWDRIVER, PRY OFF THE L/R BLACK PLASTIC UPPER SIDE TRIM PIECES (2B). **NOTE:** EACH SIDE HAS ONE LARGE AND ONE SMALL TRIM PIECE TO BE REMOVED.
- C) USING THE FLAT BLADE SCREWDRIVER, PRY OFF THE SCREW COVER (2C) FROM L/R LOWER FAIRING CORNER MOLDING TRIM (2D).
- D) USING THE #2 PHILLIPS SCREWDRIVER, REMOVE THE SCREW (2E) FROM THE L/R LOWER FAIRING CORNER MOLDING TRIM PIECES (2D).
- E) USING THE #2 PHILLIPS SCREWDRIVER, REMOVE THE 3 SCREWS (2F) FROM THE L/R FAIRING PANEL COVERS (2A).
- F) REMOVE THE L/R FAIRING PANEL COVERS (2A).
- G) DISCONNECT THE L/R LIGHT PLUGS (3A).

2. IF BEING INSTALLED ON AN SE MODEL OR OTHER MODEL UTILIZING THE CHROME CORNERING LIGHT TRIM, REMOVE THE CHROME TRIM AS IT WILL NOT ALLOW THE TOUR CORNER LIGHT GRILLE TO SIT FLUSH TO THE BIKE FOR A GOOD INSTALLATION.
3. TRIAL FIT THE L/R GRILLES (4A) OVER THE CORNERING LIGHTS (2G) IN THE FAIRING PANEL COVERS (2A) TO IDENTIFY THE "BEST FIT" POSITION.
4. PRESS EIGHT HOLE MARKERS (4B) OVER THE SCREW HOLES (4C) IN THE L/R GRILLES (4A). PEEL BACKING FROM MARKERS.
5. CAREFULLY POSITION L/H GRILLE (4A) OVER THE CORNERING LIGHT (2G) IN THE "BEST FIT" POSITION FOUND IN STEP 3 AND PRESS FIRMLY ON GRILLE TO SET THE HOLE MARKERS (4B).
6. GENTLY REMOVE THE GRILLE (4A) MAKING CERTAIN THE MARKERS (5A) REMAIN ON THE FAIRING SIDE COVER (5B).
7. USING A CENTER PUNCH AND HAMMER, MARK THE HOLE CENTERS WITHIN THE HOLE MARKERS (5A).
8. UNHOOK THE TWO SPRINGS (3B) FROM THE FAIRING BRACKETS (3C) (IF INSTALLING ON AN SE MODEL WITH OEM LIGHTS, THERE WILL BE SCREWS HOLDING THE LIGHT ON AND NOT SPRINGS) AND REMOVE THE L/H CORNERING LIGHT (3D) FROM THE L/H FAIRING PANEL COVER (3E).
9. USING THE 3/16" DRILL BIT, CAREFULLY DRILL THE MOUNTING HOLES IN THE L/H SIDE COVER (5B) **NOTE:** IN ORDER TO ASSURE A CUSTOM FIT, DRILLING ONE HOLE AT A TIME, MOUNTING THE GRILLE AND CONFIRMING THE LOCATION OF THE OTHER HOLES IS RECOMMENDED. **IMPORTANT:** EVERY EFFORT MUST BE MADE TO AVOID SCRATCHING THE PAINTED SURFACE WHEN DRILLING. USING A SLOW SPEED DRILL WILL HELP YOUR CONTROL.
10. REMOVE THE HOLE MARKERS (5A) AND ATTACH THE L/H GRILLE (4A) USING THE PROVIDED SELF-TAPPING SCREWS AND WASHERS FROM THE INSIDE OF THE FAIRING. **NOTE:** BE EXTREMELY CAREFUL THAT YOU DO NOT OVER TIGHTEN THE SCREWS FORCING THEM TO POKE THROUGH THE CORNERING GRILLE.
11. REPEAT STEPS 4 THROUGH 10 FOR THE R/H GRILLE.
12. RE-INSTALL ALL ITEMS REMOVED BY REVERSING STEP 1 (A THROUGH G) AND STEP 8.

OVER

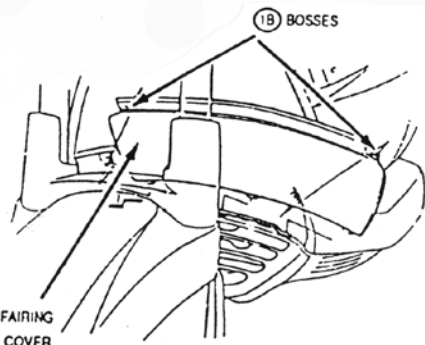

FIGURE #1

1A FAIRING FRONT COVER
1B BOSSES

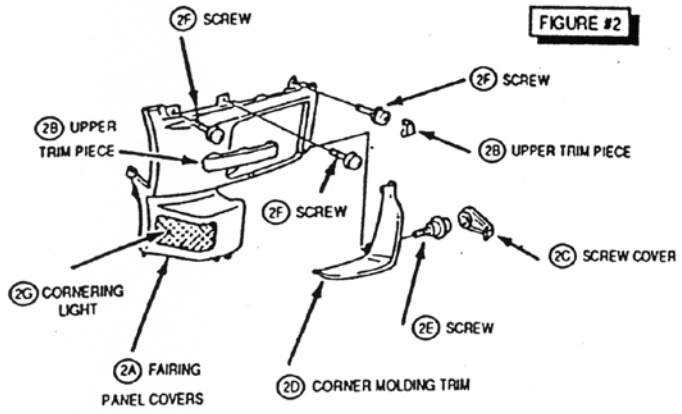

FIGURE #2

2F SCREW
2B UPPER TRIM PIECE
2C CORNERING LIGHT
2A FAIRING PANEL COVERS
2D CORNER MOLDING TRIM
2E SCREW
2C SCREW COVER

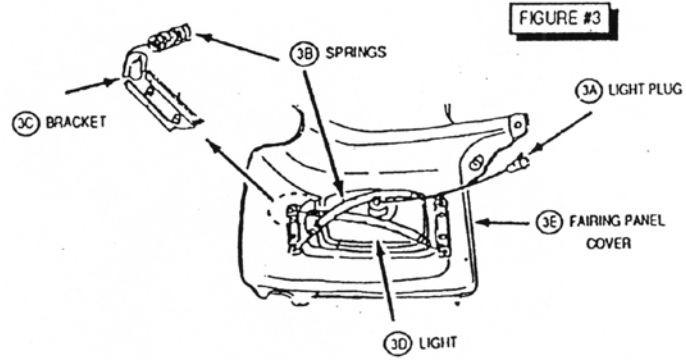

FIGURE #3

3B SPRINGS
3A LIGHT PLUG
3E FAIRING PANEL COVER
3D LIGHT
3C BRACKET

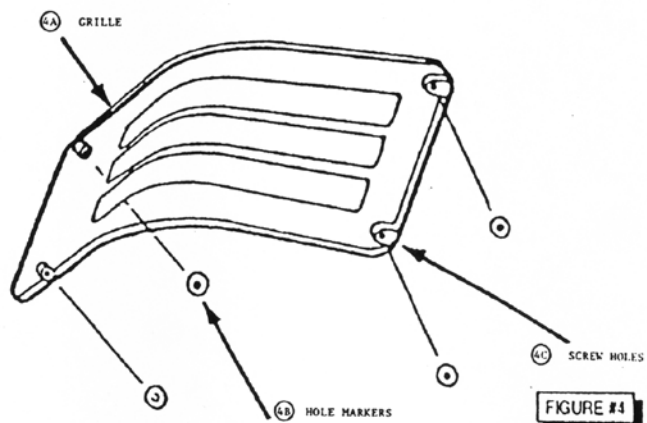

FIGURE #4

4A GRILLE
4B HOLE MARKERS
4C SCREW HOLES

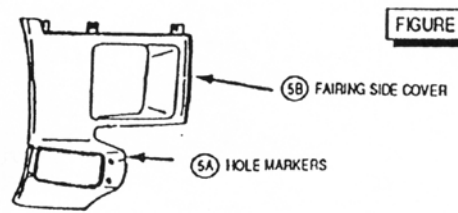

FIGURE #5

5B FAIRING SIDE COVER
5A HOLE MARKERS