

BIG BIKE PARTS® INSTALLATION INSTRUCTIONS

Copyright© 2007 by Big Bike Parts, Inc. No part of this instruction sheet may be reproduced without the written permission of Big Bike Parts, Inc.

PART NO. 55-333

MINI ELLIPTICAL DRIVING KIT
HONDA VTX1300C

Revised 07/18/07

TOOLS NEEDED:	PHILLIPS SCREW DRIVER	13MM SOCKET WRENCH	DRILL	4MM ALLEN WRENCH	FILE
	6MM ALLEN WRENCH	5MM ALLEN WRENCH	1/4" BIT	2MM ALLEN WRENCH	THREADLOCKER
	CLEAR SILICONE SEALANT	10MM SOCKET WRENCH	3/16" BIT	FINE TIPPED MARKER	

NOTE: THREAD LOCKER SHOULD BE USED ON ALL HARDWARE.

NOTE: SET SCREWS FOR THE DRIVING LIGHT VISOR ON THE MINI HALOGENS NEED TO BE REMOVED AND REINSTALLED WITH THREADLOCKER.

INSTALLATION:

1. DISCONNECT THE NEGATIVE BATTERY CABLE.
2. USING A 5MM ALLEN WRENCH REMOVE THE FRONT TURN SIGNALS BY REMOVING THE BOLT AT THE BACK OF THE FORK. THEN REMOVE THE METAL COVER AND SPACER AND PULL THE TURN SIGNAL OFF THE FORK. FOLLOW THE TURN SIGNAL WIRES AND DISCONNECT THEM FROM THE BIKE. REPEAT FOR THE OTHER SIDE. BE SURE TO NOTE AS TO WHICH TURN SIGNALS IS THE LEFT AND RIGHT.

NOTE: STEPS 3-13 & 15 ARE FOR INSTALLING OEM TURNSIGNALS WITH 82-222T ADAPTERS.

3. REMOVE THE LENS FROM THE OEM TURN SIGNALS (G) BY REMOVING THE SCREW ON THE SIDE. WITH THE LENS REMOVED, REMOVE THE BULB. THEN POP THE PLATE LOOSE IN THE OEM TURN SIGNAL BY REMOVING THE TWO SCREWS.
4. CUT THE BLUE AND ORANGE PLUGS OFF THE TURN SIGNAL WIRES ABOUT 1" DOWN FROM THE ENDS OF THE PLUGS. YOU MAY NEED TO ADD WIRE LENGTH LATER ON.
5. PULL THE BLACK RUBBER ADAPTER OUT OF THE OEM TURN SIGNAL (G) AND PULL THE WIRES OUT OF THE RUBBER ADAPTER. THEN REMOVE THE METAL BRACKET ON THE INSIDE OF THE TURN SIGNAL HOUSING.
6. TAKE THE TURN SIGNAL ADAPTER (H) AND PLACE AS SHOWN IN DIAGRAM 1. MAKE SURE THAT THE CENTER OF THE HOLE ON THE ADAPTER LINES UP WITH THE CENTER MARK ON THE OEM TURN SIGNAL (G) AND MARK THE CENTER OF THE HOLE WITH A FINE TIPPED MARKER.
7. DRILL A 1/4" HOLE ON YOUR MARK ON THE TURN SIGNAL (G). BE CAREFUL AS TO NOT DRILL THRU BOTH SIDES OF THE TURN SIGNAL. USING A FILE REMOVE MATERIAL ON THE INSIDE OF THE HOUSING SO THE TAB ON THE ADAPTER LAYS FLAT ON THE INSIDE FACE OF THE HOUSING.
8. USING A CLEAR SILICONE SEALANT LAY A SMALL BEAD AROUND THE TOP OF THE TURN SIGNAL (G). THEN PLACE THE TURN SIGNAL ADAPTER (H) INTO PLACE AND SECURE WITH THE M6-1.0 X 10MM LONG BUTTON SOCKET HEAD CAP SCREW (B).
9. USING THE 10MM SOCKET WRENCH REMOVE THE TWO NUTS ON THE BOTTOM OF THE TRIPLE TREE HOLDING THE HEADLIGHT BRACKET. LIFT THE HEADLIGHT BRACKET OFF FROM THE TRIPLE TREE, AND SLIDE THE MOUNTING PLATE (A) BETWEEN THE TOP OF THE TRIPLE TREE AND BENEATH THE HEADLIGHT BRACKET. REINSTALL THE NUTS JUST REMOVED AND TIGHTEN DOWN.
10. REASSEMBLE THE TURN SIGNALS IN REVERSE ORDER OF STEP 5.
11. INSTALL THE NEW MINI LIGHTS (E) ON TO THE LIGHT BAR (D) USING THE THREADED STEM (L) AND LOCK NUTS (F) PROVIDED WITH THE LIGHTS. POSITION THE LIGHTS. TIGHTEN WITH A 13MM SOCKET. (CONNECT THE GROUND WIRE WITH THE RING TERMINAL TO THE M6 - 1.0 X20MM LONG (M) SOCKET HEAD CAP SCREW AND THE POSITIVE WIRE WITH BULLET CONNECTOR WILL GO INTO THE EXTRA HOLE ON TOP OF THE LIGHT BAR. YOU WILL HAVE TO REMOVE THE BULLET CONNECTOR TO FIT INTO HOLE.)
12. ROUTE THE OEM TURN SIGNAL WIRES AND MINI LIGHT WIRE INTO THE LIGHT BAR (D). YOU MAY HAVE TO CUT OFF OEM BULLET CONNECTORS AND ADD NEW ONES AFTER THEY ARE ROUTED.
13. THE TURN SIGNAL ADAPTERS (H) WITH OEM TURN SIGNALS (G) NEED TO BE POSITIONED INTO THE LOWER ENDS OF THE NEW LIGHT BAR (D) AND SECURED WITH THE SET SCREWS (K). THERE ARE THREE SET SCREWS ON EACH SIDE.
14. USING THE M6 - 1.0 X 16MM LONG BUTTON SOCKET HEAD CAP SCREWS AND LOCK WASHERS (C), INSTALL THE LIGHT BAR (D) ONTO THE MOUNTING PLATE (A). TIGHTEN SECURELY WITH A 4MM ALLEN WRENCH.
15. RE-ROUTE THE OEM TURN SIGNAL WIRES. YOU MAY HAVE TO ADD WIRE LENGTH FOR THE WIRES TO REACH. REATTACH THE CONNECTORS TO THE WIRES AND RECONNECT THE CONNECTORS TO THE BIKE.

16. LOCATE YOUR BIKE'S BATTERY, FUSE BLOCK, AND/OR ACCESSORY TERMINALS AND WIRE ACCORDING TO THE DIAGRAM ON THE BACK OF THE OTHER SHEET.

NOTE: IF A 13-207 SWITCH BLOCK IS PURCHASED, STEPS C & E CAN BE SKIPPED AND PLUG ONE OF THE SWITCHES INTO THE RELAY.

- A) CONNECT THE BULLET CONNECTORS ON BLACK WIRES TO BULLET CONNECTORS ON LIGHT.
- B) WIRE SMALL GREEN AND RED HARNESS WITH IN-LINE FUSE DIRECTLY TO THE BATTERY: RED (+) POSITIVE, GREEN (-) NEGATIVE.
- C) FIND A CONVENIENT PLACE TO INSTALL THE SWITCH. DRILL A PILOT HOLE FIRST AND THEN DRILL A 13/16" HOLE. (CAN BE INSTALLED IN SIDE COVER.)
- D) ROUTE WIRE HARNESS, AND PLUG THE THREE SPADE CONNECTORS TO SWITCH PER DIAGRAM: (GREEN=GROUND: ORANGE=SUPPLY: BLUE=LEAD.)
- E) CONNECT THE RING TERMINAL TO THE BATTERY GROUND AND SPLICE THE T-TAP INTO A KEYED POWER SOURCE AND CONNECT THE MALE SPADE.
- F) CONNECT THE REMAINING FIVE LEADS (2 BLACK, 1 RED, AND 1 GREEN) TO THE RELAY PROVIDED AS PER DIAGRAM.

17. TEST LIGHTS FOR PROPER OPERATION BEFORE REINSTALLING ANY REMOVED SIDE COVERS, SEATS, ETC. SECURE RELAY TO KEEP FROM BOUNCING.

18. REINSTALL THE NECK COVERS BACK ON THE BIKE IN THE REVERSE ORDER OF REMOVAL.

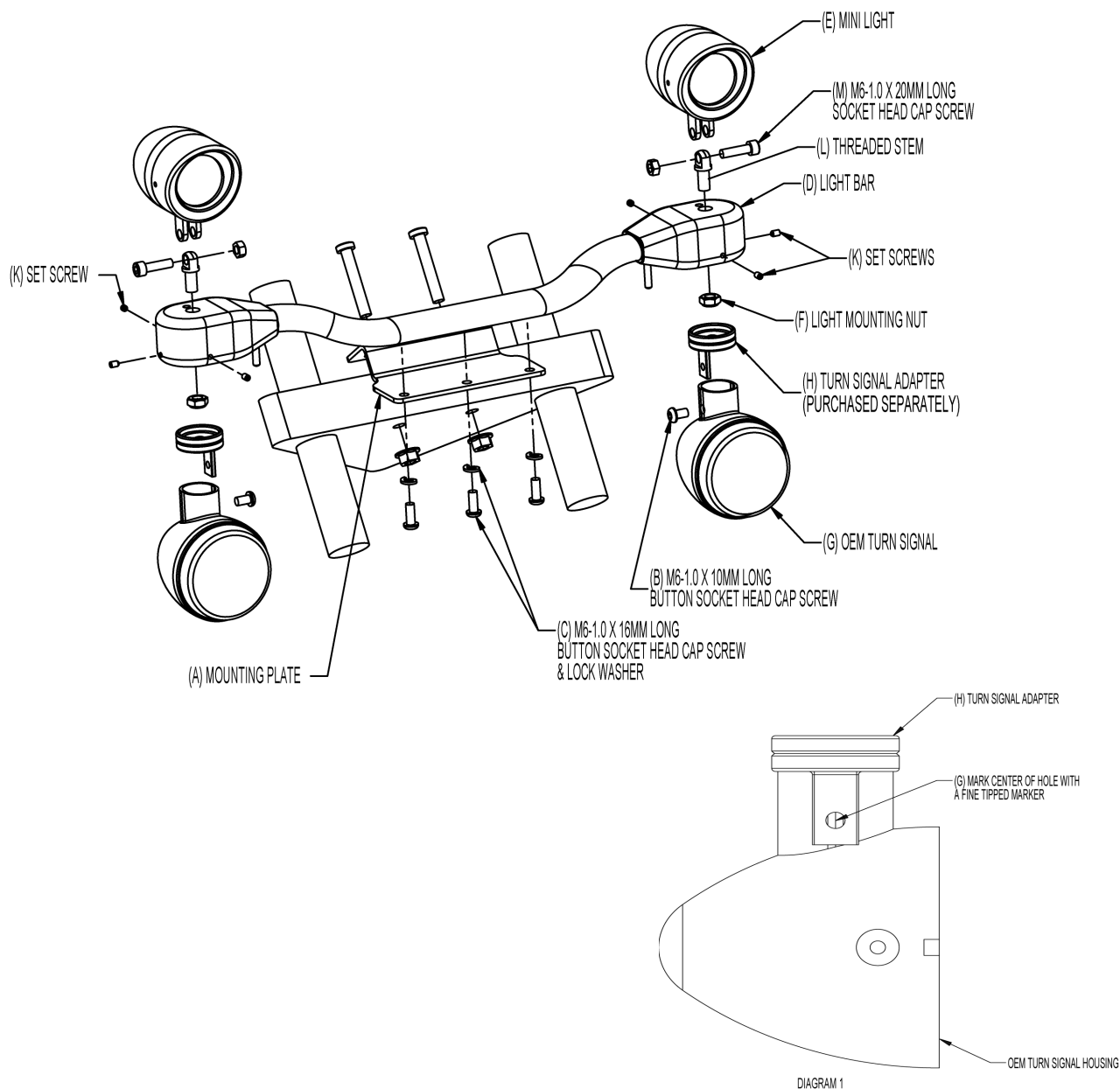

BIG BIKE PARTS® INSTALLATION INSTRUCTIONS

Copyright© 2007 by Big Bike Parts, Inc. No part of this instruction sheet may be reproduced without the written permission of Big Bike Parts, Inc.

PART NO. 55-333

MINI ELLIPTICAL DRIVING KIT
HONDA VTX1300 RETRO
VTX1800, VALKYRIE

Revised 07/18/07

TOOLS REQUIRED:	#2 PHILLIPS SCREWDRIVER	13MM SOCKET WRENCH	12MM WRENCH	5MM ALLEN WRENCH
	DRILL	10MM WRENCH	2MM ALLEN WRENCH	6MM ALLEN WRENCH
	THREADLOCKER	13/16" DRILL BIT	4MM ALLEN WRENCH	

NOTE: THREAD LOCKER SHOULD BE USED ON ALL HARDWARE.

NOTE: SET SCREWS FOR THE DRIVING LIGHT VISOR ON THE MINI HALOGENS NEED TO BE REMOVED AND REINSTALLED WITH THREADLOCKER.

INSTALLATION:

1. DISCONNECT THE NEGATIVE BATTERY CABLE.
2. USING PHILLIPS SCREWDRIVER, REMOVE THE TWO SCREWS ON THE SIDE OF THE HEADLIGHT AND REMOVE THE HEADLIGHT.
3. USING 13MM WRENCH REMOVE THE TWO NUTS UNDER THE LOWER FORK ASSEMBLY WHICH HOLD THE OEM HEADLIGHT BRACKET. (THESE NUTS WILL NOT BE REUSED)
4. INSTALL THE TWO LONG EXTENSION NUTS (C) IN PLACE OF THE OEM NUTS AND TIGHTEN SECURELY WITH A 12MM WRENCH.
5. USING THE TWO M8 - 1.25 X 20MM LONG SOCKET HEAD CAP SCREWS AND LOCK WASHERS PROVIDED (D) ATTACH MOUNTING PLATE (E) ONTO THE EXTENSION NUTS (C) AND TIGHTEN USING 6MM ALLEN WRENCH.
6. INSTALL THE MINI LIGHTS (H) ONTO THE LIGHT BAR (G) USING THE THREADED STEM (P) AND LOCK NUTS. (J) PROVIDED WITH THE LIGHTS. POSITION THE LIGHTS. TIGHTEN WITH A 13MM SOCKET. (CONNECT THE GROUND WIRE WITH THE RING TERMINAL TO THE M6 - 1.0 X 20MM LONG SOCKET HEAD CAP SCREW (O) AND THE HOT WIRE WITH BULLET CONNECTOR WILL GO INTO THE EXTRA HOLE ON TOP OF LIGHT BAR.)

NOTE: STEPS 7,8,9, & 11 USE FOR INSTALLING OEM TURN SIGNALS WITH PURCHASE OF 55-122T ADAPTERS.

7. TO RELOCATE THE OEM TURN SIGNALS (K) REMOVE THEM USING A 5MM ALLEN WRENCH, UNPLUG THE WIRE LEADS Q THAT GO INTO THE HEADLIGHT HOUSING.
8. INSTALL EACH OEM TURN SIGNAL (K) ONTO THE TURN SIGNAL ADAPTER (L) ROUTING THE WIRES THROUGH THE EXTRA HOLE IN THE ADAPTER. THEN USING THE M6 - 1.0 X 15 MM LONG BUTTON SOCKET HEAD CAP SCREW (M) TIGHTEN WITH A 5MM ALLEN WRENCH.
9. ROUTE THE TURN SIGNAL WIRES AND MINI LIGHT WIRE INTO THE LIGHT BAR (G).
10. THE TURN SIGNAL ADAPTER (L) WITH OEM TURN SIGNAL (K) CAN BE POSITIONED INTO THE LOWER ENDS OF THE LIGHT BAR (G) AND SECURED WITH THE SET SCREWS (N). THERE ARE THREE SET SCREWS ON EACH SIDE.
11. USING THE M6 - 1.0 X 16MM LONG BUTTON SOCKET HEAD CAP SCREWS AND LOCK WASHERS PROVIDED (F) INSTALL THE LIGHT BAR (G) ONTO THE MOUNTING PLATE (E). TIGHTEN SECURELY WITH A 4MM ALLEN WRENCH.
12. RE-ROUTE THE TURN SIGNAL WIRES INTO THE HEADLIGHT HOUSING AND RE-CONNECT AS THEY WERE.
13. LOCATE YOUR BIKE'S BATTERY, FUSE BLOCK, AND/OR ACCESSORY TERMINALS AND WIRE ACCORDING TO THE DIAGRAM ON BACK.

NOTE: IF A 13-207/52-605/52-605L SWITCH BLOCK IS PURCHASED, STEPS C & E CAN BE SKIPPED AND PLUG ONE OF THE SWITCHES INTO THE RELAY.

- A) CONNECT THE BULLET CONNECTORS ON BLACK WIRES TO THE BULLET CONNECTORS FROM LIGHTS.
 - B) WIRE SMALL GREEN AND RED HARNESS WITH IN-LINE FUSE DIRECTLY TO BATTERY: RED (+) POSITIVE, GREEN (-) NEGATIVE.
 - C) FIND A CONVENIENT PLACE TO INSTALL THE SWITCH. DRILL A PILOT HOLE FIRST AND THEN DRILL A 13/16" HOLE.
 - D) ROUTE WIRE HARNESS AND PLUG THREE SPADE CONNECTORS TO SWITCH PER DIAGRAM: (GREEN=GROUND, ORANGE=SUPPLY, BLUE=LEAD.)
 - E) CONNECT THE RING TERMINAL TO THE BATTERY GROUND AND SPLICE THE T-TAP INTO A KEYED POWER SOURCE AND CONNECT THE MALE SPADE.
 - F) CONNECT THE REMAINING FIVE LEADS (2 BLACK, 1 RED, 1 BLUE, AND 1 GREEN) TO THE RELAY PROVIDE AS PER DIAGRAM.
13. TEST LIGHTS FOR PROPER OPERATION BEFORE REINSTALLING ANY REMOVED SIDE COVERS, SEATS, ETC. SECURE RELAY TO KEEP FROM BOUNCING. SEE THAT ALL FITTINGS, SCREWS, ETC. ARE SECURE, INCLUDING THE MINI HALOGEN VISOR SET SCREWS.

