

BIG BIKE PARTS® INSTALLATION INSTRUCTIONS

Copyright© 2005 by Big Bike Parts, Inc. No part of this instruction sheet may be reproduced without the written permission of Big Bike Parts, Inc.

PART NO. 63-143

MINI ELLIPTICAL DRIVING KIT
YAMAHA V-STAR 650 CLASSIC

Revised 11/5/12

TOOLS NEEDED:	#2 PHILLIPS SCREWDRIVER	5MM ALLEN WRENCH	8MM WRENCH	13/16" DRILL BIT
	DRILL	6MM ALLEN WRENCH	10MM WRENCH	
	13MM SOCKET WRENCH	2MM ALLEN WRENCH	4MM ALLEN WRENCH	

NOTE: THREAD LOCKER SHOULD BE USED ON ALL HARDWARE.

NOTE: SET SCREWS FOR THE DRIVING LIGHT VISOR ON THE MINI HALOGENS NEED TO BE REMOVED AND REINSTALLED WITH THREADLOCKER.

INSTALLATION:

1. DISCONNECT THE NEGATIVE BATTERY CABLE.
2. USING PHILLIPS SCREWDRIVER, REMOVE THE TWO SCREWS ON THE SIDE OF THE HEADLIGHT AND REMOVE THE HEADLIGHT.
3. REMOVE THE COVER OVER OEM TURN SIGNAL LIGHT BAR.
4. ON EACH OEM TURN SIGNAL FOLLOW WIRES INTO THE HEADLIGHT HOUSING AND DISCONNECT THEM. UNPLUG THE BULLET CONNECTORS.
5. USING 6MM ALLEN WRENCH REMOVE THE TWO SOCKET HEAD CAP SCREWS (B) HOLDING THE TURN SIGNAL OEM LIGHT BAR TO FORKS (KEEP SCREWS).
6. USING 8MM AND 10MM WRENCH REMOVE THE TURN SIGNALS (G) FROM THE OEM LIGHT BAR (KEEP SCREWS AND RUBBER).
7. INSTALL MOUNTING PLATE (A) TO FORKS USING SCREWS THAT WERE REMOVED IN STEP 5.
8. INSTALL THE NEW MINI LIGHTS (E) ONTO THE LIGHT BAR (D) USING THE THREADED STEM (L) AND LOCK NUTS (F) PROVIDED WITH THE LIGHTS. POSITION THE LIGHTS. TIGHTEN WITH A 13MM SOCKET. (CONNECT THE GROUND WIRE WITH THE RING TERMINAL TO THE M6 - 1.0 X 20MM LONG (M) SOCKET HEAD CAP SCREW AND THE POSITIVE WIRE WITH BULLET CONNECTOR WILL GO INTO THE EXTRA HOLE ON TOP OF LIGHT BAR WILL HAVE TO REMOVE BULLET CONNECTOR TO FIT INTO HOLE).

NOTE: STEPS 9,10,11, & 13 ARE FOR INSTALLING OEM TURN SIGNALS WITH 62-112T ADAPTERS.

9. INSTALL EACH OEM TURN SIGNAL (G) ONTO THE NEW TURN SIGNAL ADAPTER (H) ROUTING THE WIRES THROUGH THE HOLE IN THE ADAPTER. USING THE BOLTS REMOVED IN STEP 6 SECURE THE TURN SIGNAL TO THE ADAPTER.
10. ROUTE THE OEM TURN SIGNAL WIRES AND MINI LIGHT WIRE INTO THE LIGHT BAR (D). YOU MAY HAVE TO CUT OFF OEM BULLET CONNECTORS AND ADD NEW ONES AFTER THEY ARE ROUTED.
11. THE TURN SIGNAL ADAPTERS (H) WITH OEM TURN SIGNALS (G) NEED TO BE POSITIONED INTO THE LOWER ENDS OF THE NEW LIGHT BAR (D) AND SECURED WITH THE SET SCREWS (K). THERE ARE THREE SET SCREWS ON EACH SIDE.
12. USING THE M6 - 1.0 X 16MM LONG BUTTON SOCKET HEAD CAP SCREWS AND LOCK WASHERS (C) INSTALL THE LIGHT BAR (D) ONTO THE MOUNTING PLATE (A). TIGHTEN SECURELY WITH A 4MM ALLEN WRENCH.
13. RE-ROUTE THE OEM TURN SIGNAL WIRES INTO THE HEADLIGHT HOUSING AND RE-CONNECT AS THEY WERE.
14. LOCATE YOUR BIKE'S BATTERY, FUSE BLOCK AND /OR ACCESSORY TERMINALS AND WIRE ACCORDING TO THE DIAGRAM ON BACK.

NOTE: IF A 13-207 SWITCH BLOCK IS PURCHASED, STEPS C & E CAN BE SKIPPED AND PLUG ONE OF THE SWITCHES INTO THE RELAY.

- A) CONNECT THE BULLET CONNECTORS ON BLACK WIRES TO BULLET CONNECTORS ON LIGHT.
- B) WIRE SMALL GREEN AND RED HARNESS WITH IN-LINE FUSE DIRECTLY TO BATTERY: RED (+) POSITIVE, GREEN (-) NEGATIVE.
- C) FIND A CONVENIENT PLACE TO INSTALL SWITCH. DRILL A PILOT HOLE FIRST AND THEN DRILL A 13/16" HOLE. (CAN BE INSTALLED IN SIDE COVER.)
- D) ROUTE WIRE HARNESS AND PLUG THE THREE SPADE CONNECTORS TO SWITCH PER DIAGRAM: (GREEN=GROUND: ORANGE=SUPPLY: BLUE=LEAD.)
- E) CONNECT THE RING TERMINAL TO THE BATTERY GROUND AND SPLICE THE T-TAP INTO A KEYED POWER SOURCE AND CONNECT THE MALE SPADE.
- F) CONNECT THE REMAINING FIVE LEADS (2 BLACK, 1 RED, 1 BLUE, AND 1 GREEN) TO THE RELAY PROVIDED AS PER DIAGRAM.

15. TEST LIGHTS FOR PROPER OPERATION BEFORE REINSTALLING ANY REMOVED SIDE COVERS, SEATS, ETC. SECURE RELAY TO KEEP FROM BOUNCING.

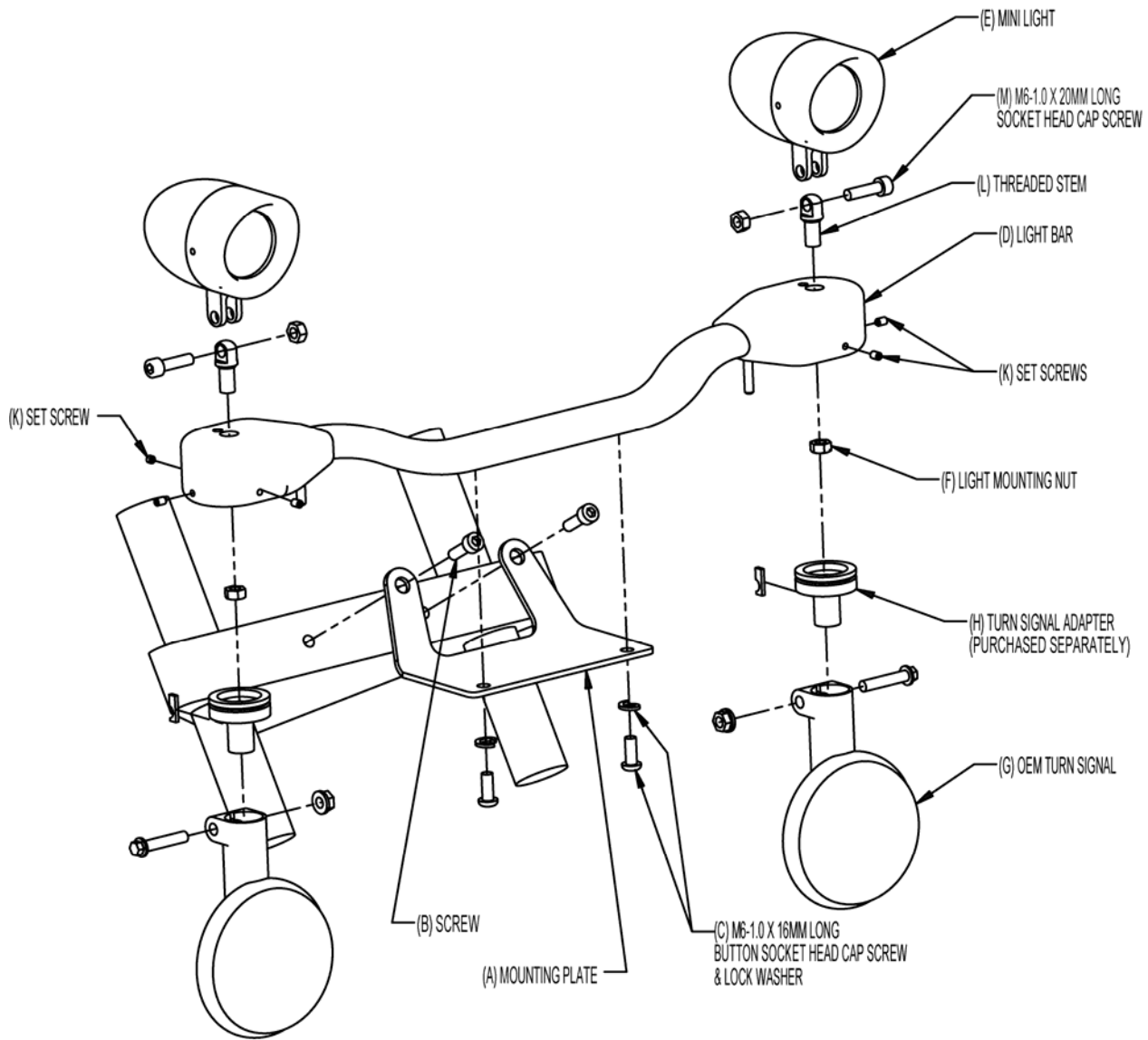

63-143

